

NOTE: Lease boundaries are to the public face of glass unless noted otherwise.

Sheet
1 of
1

BENNETT + BENNETT

PO Box 5021, GCMC QLD 9726
Ph: (07) 5631 8000
mail@bennettandbennett.com.au

Surveying, Town Planning & Spatial Services
GOLD COAST | BRISBANE | SUNSHINE COAST | IPSWICH
www.bennettandbennett.com.au

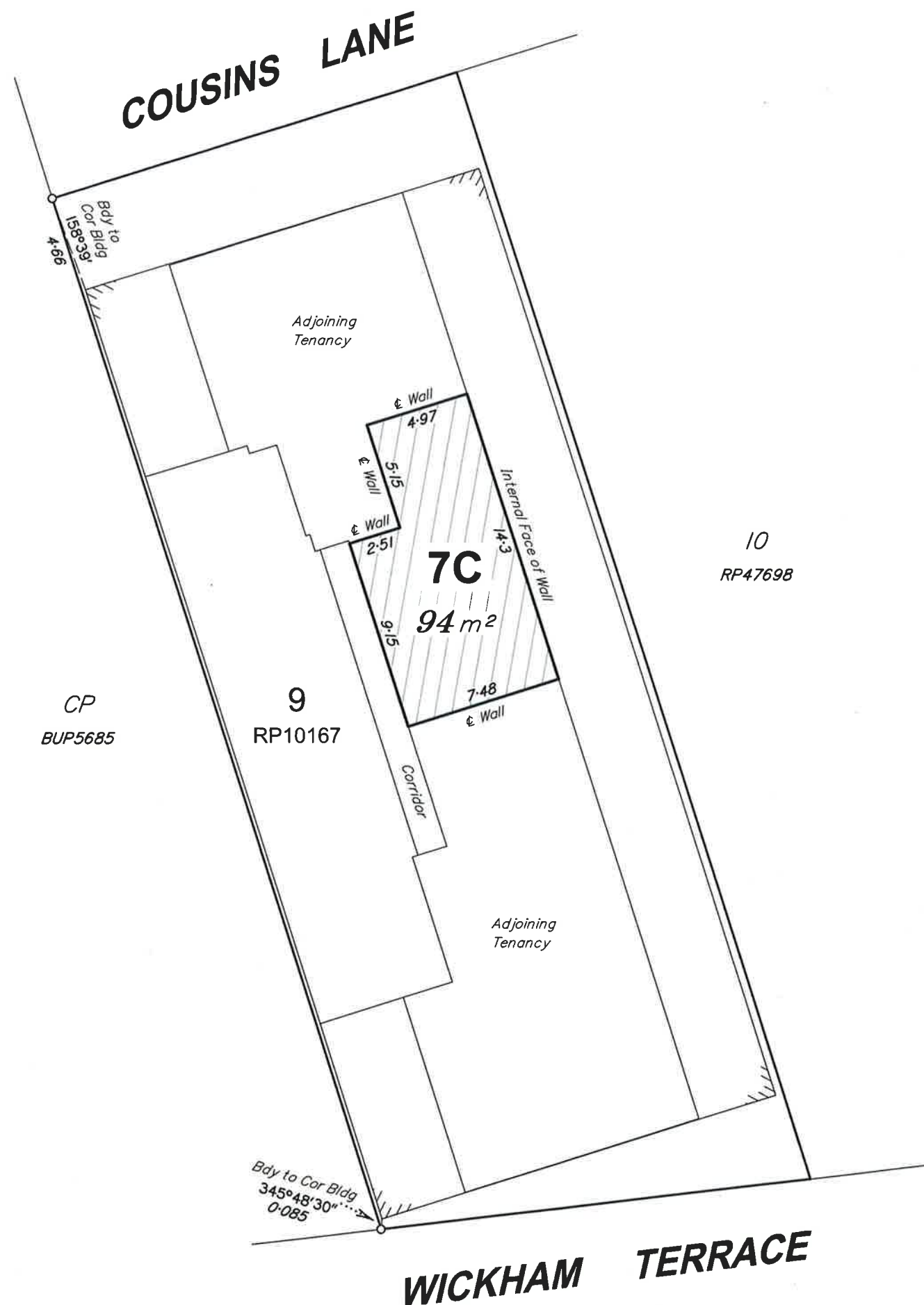

10
RP47698

CP
BUP5685

9
RP10167

7C
94m²

Adjoining
Tenancy

Bdy to Cor Bldg
345°48'30" 0-085

WICKHAM TERRACE

Scale 1:250



- NOTES:
1. Drawn to Scale on A3 sheet
 2. Lease area measured in accordance with the P.C.A. recommendations for Net Lettable Area. (NLA)
 3. Title Reference : 16424099
 4. Adjoining tenancies shown have been compiled from other sources and are diagrammatic only.
 5. Lease Boundaries are defined by structural elements, distances shown are indicative only unless noted otherwise.
 6. Meridian of RP10167

A	Original Issue	JEW	06/07/2017
Issue	Revision	Int	Date

Title:
Plan of Lease Area '7C'
being part of the Seventh Floor
of the building erected
on Lot 9 on RP10167

Client: **DEMARTINI**

Locality: **SPRING HILL**
Local Gov: **BCC** Prepared By: **JEW**
Surveyed By: **PS** Approved: **PS**
Date Created: **06/07/2017** Scale: **1:250**
Comp File: **09051.12D**
Plan No: **09051_030_LEA_A**

A3