

All drawings are the property of Empire Office Furniture (EOF) and only to be used for design, quoting & installation purposes between EOF and client. All furniture items shown on drawings are for pricing purposes only. Furniture selection and dimensions to be verified by EOF and approved by the client after the final site check and before manufacture.

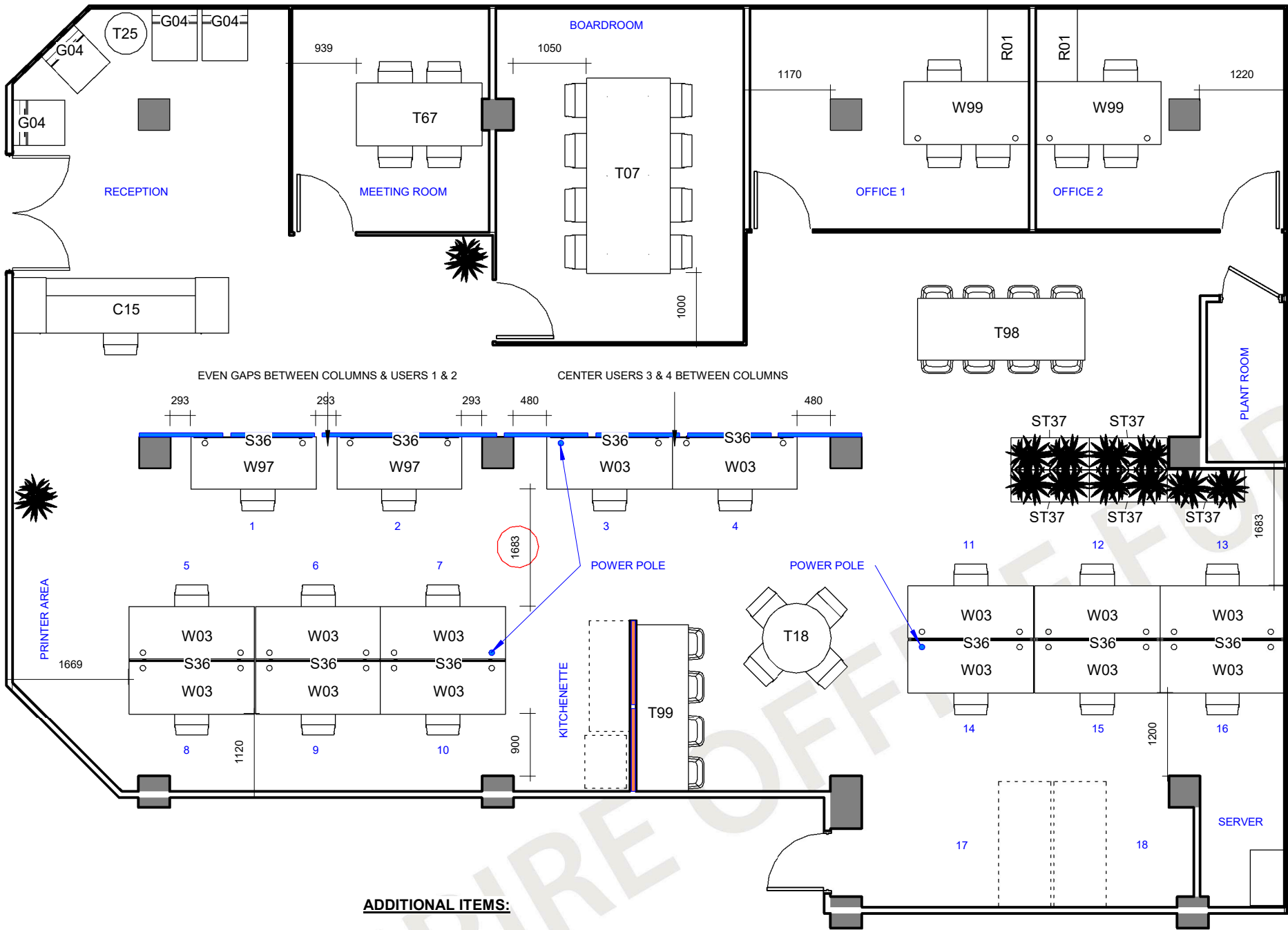

ADDITIONAL ITEMS:

- 19 x BUILT STRONG MOBILE PEDESTAL
- 17 x A-TEAM HIGH BACK MESH CHAIR (WORTLEY ACCESS - TANGERINE)
- 12 x CHARTER MESH CHAIR (BLACK MESH)
- 2 x WING EXECUTIVE CHAIR (BLACK)
- 4 x SONAR CANTILEVER VISITOR CHAIR
- 2 x SHAPE SUSPENDED MODESTY PANEL
- 4 x PLAY SLED CHAIR (BRIGHT ORANGE FABRIC)
- 12 x PLAY BARSTOOL (BRIGHT ORANGE FABRIC)

- 8 x ACOUSTIC HANGING SCREENS 2400 x 1200 (ZENITH)
- 2 x ACOUSTIC HANGING SCREENS 1200 x 800 (ZENITH)

- HANGING ACOUSTIC SCREENS FLOOR TO CEILING
- HANGING ACOUSTIC SCREENS @ 1300H APPROX.
- POTENTIAL 'FUTURE' WORKSTATIONS

NOTE: NO FINAL SITE MEASURE WAS UNDERTAKEN PRIOR TO THE ISSUE OF THIS INSTALL DRAWING

1 INSTALL DRAWING
1 : 75

Note : Softwiring cable management included (4 power & 3 data outlets under worktops) for each workstation.
Allowance for up to a maximum of 24 GPO per 20 AMP circuit.

DESK SCHEDULE			
CODE	DESCRIPTION	FINISH	COUNT
C15	RECEPTION COUNTER 3100 x 810 x 1150 (H)	DARK CHOCOLATE/WHITE	1

SCHEDULE			
CODE	DESCRIPTION	FINISH	COUNT
R01	RETURN 1050 x 600	RURAL OAK	2
T67	TABLE 1800 x 900 x 725 (H)	RURAL OAK	1
T98	BENCH 2400 x 900 x 1050H	WHITE	1
T99	BENCH 2400 x 750 x 1050H	WHITE	1
W03	STRAIGHT WORKTOP 1800 x 750	WHITE	14
W97	ALTURA ELECTRIC STRAIGHT WORKTOP 1800 x 750	WHITE	2
W99	STRAIGHT WORKTOP 1800 x 900	RURAL OAK	2

SCREEN SCHEDULE			
CODE	DESCRIPTION	FINISH	COUNT
S36	SCREEN 1700W	ZENITH	10

STORAGE SCHEDULE			
CODE	DESCRIPTION	FINISH	COUNT
ST37	TAMBOUR DOOR CUPBOARD (W/ PLANTER BOX) 900 x 473 x 1016 (H)	WHITE	5

TABLE SCHEDULE			
CODE	DESCRIPTION	FINISH	COUNT
T07	RECTANGULAR BOARDROOM TABLE 2800 x 1200	RURAL OAK	1
T18	ROUND TABLE 1000 (DIA)	WHITE	1
T25	COFFEE TABLE 600 (DIA)	WHITE	1

BENCHMARK/SUNRISE SCHEDULE			
CODE	DESCRIPTION	FINISH	COUNT
G04	LION LOUNGE CHAIR 570 x 850D x 850H	DOLLY FLAME	4

INSTALLATION DRAWING APPROVAL - REVISION W

This is to authorise Empire Office Furniture to proceed with site installation as per this drawing. Any variations to this layout may incur additional charges.
Electrical: Empire supply all soft wire componentry required for this project as quoted, It is the client's responsibility to engage the services of a certified electrical contractor for the installation, connection and testing of all starter sockets and leads.
Data: Empire does not provide any data cabling or connectors.

Approved by
Print Name.....
Date.....

SALES ORDER NO: MK 35678

<div>it's easier with</div> <div>empire <small>EST 1992</small> CORPORATE PROJECTS</div>	Client: DE MARTINI FLETCHER INSTALL DRAWING	REV	DESCRIPTION	DATE	CERTIFICATION Certification and compliance of appropriate building codes and standards to be confirmed with certifiers by client prior to installation as is not the responsibility of EOF.	Floor Level	45 Victoria Street, Mackay		
		W	INSTALL DRAWING	21.08.19		TWO			
www.empirefurniture.com.au						Project Reference		MK-DEMART	W 201
		Date		21.08.19					
		Drawn by		SK					
		Checked by		CE					
		Scale		1 : 75					