



Bennett & Bennett

Consulting Surveyors, Development Consultants
& Town Planners

All mail to: PO Box 5021, GCMC., Qld. 9726
mail@bennettandbennett.com.au
BBH Pty. Ltd. A.C.N. 010 427 531

GOLD COAST OFFICE
95 Upton Street, Bundall
Ph (07) 5574 0733
Fax (07) 5574 0202

BRISBANE OFFICE
Level 3,
490 Upper Edward St.
Spring Hill
Ph (07) 3839 7200
Fax (07) 3839 7277

COOMERA OFFICE
21 Dreamworld Parkway,
Coomera
Ph (07) 5573 6177
Fax (07) 5529 4342

Rev	Date

NOTES:

1. Drawn to Scale on A3 sheet
2. Lease area measured in accordance with the P.C.A. recommendations for G.L.A (Gross Lettable Area.)
3. Adjoining tenancies shown have been compiled from other sources and are diagrammatic only.
4. Lease Boundaries are defined by structural elements, distances shown are indicative only unless noted otherwise.

TITLE "PLAN OF LEASE AREA 14B"

being part of the Ground Floor
of the building 'C' erected on
Lot 39 on RP212905
"25 MICHLIN STREET
MOOROOKA"

CLIENT De Martini	
Drawn DC	Parish YEERONGPILLY
Surv'd CJP	County STANLEY
Authorised	Job Ref. 06205
L/Book	Comp File
Date 7/08/2007	Dwg File 06205LEA3
SCALE 1:1000	PLAN No. 5
	Rev.

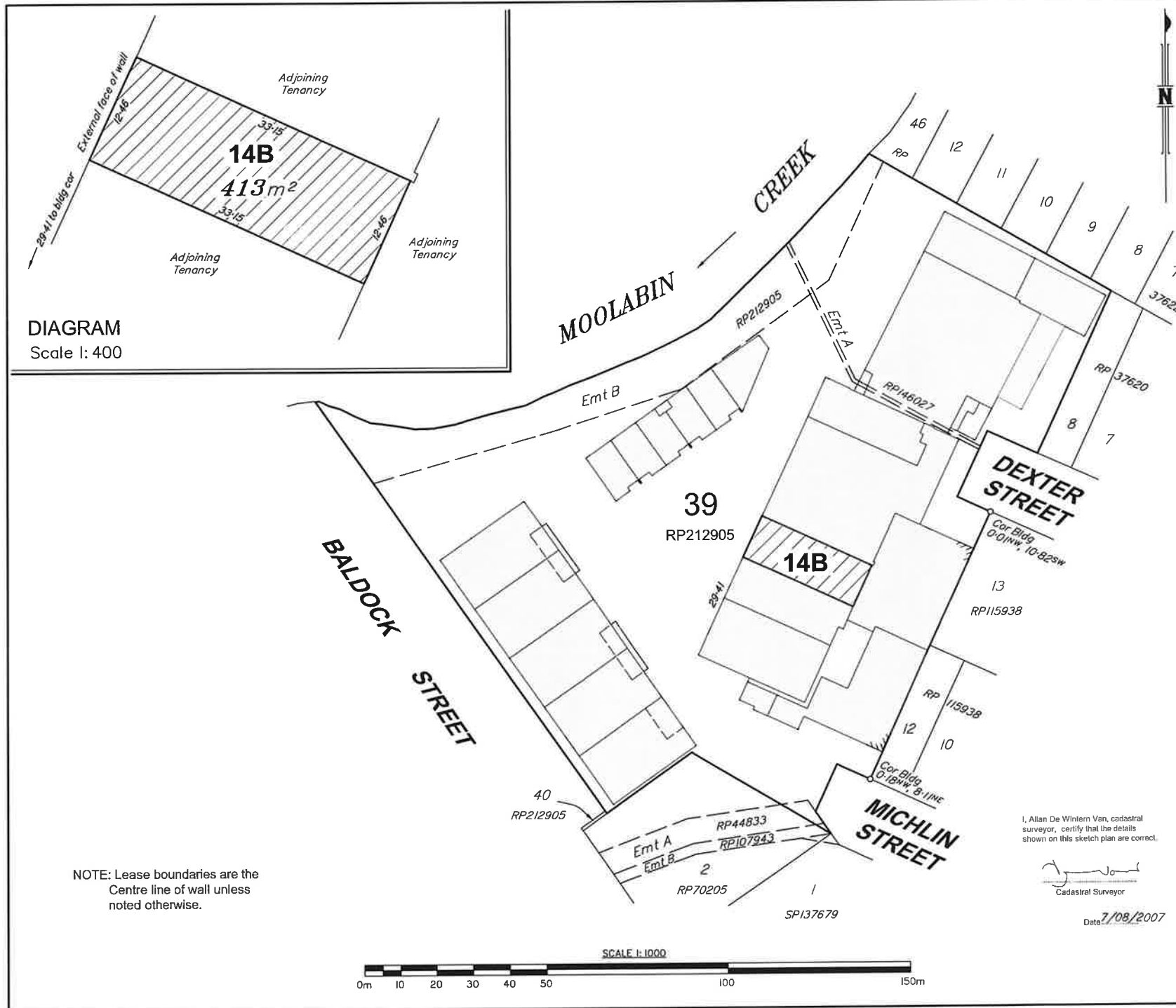

I, Allan De Wintern Van, cadastral
surveyor, certify that the details
shown on this sketch plan are correct.

Cadastral Surveyor

Date **7/08/2007**

SCALE 1:1000

